



# MasterTrak Plus

COMPLETE TRACKING MANAGEMENT SYSTEM



## MTRAK SYNC MODULE...

MTrak Sync is a PC-based program which allows the User to automatically update MasterTrak Plus with the In's, Out's and Physical Inventory of all file folder transactions, recorded on a Windows® CE compatible handheld portable barcode reading unit.



### NO MORE DOWNLOADING OR PROCESSING

MTrak Sync, through the use of Microsoft's ActiveSync, is able to "talk to MasterTrak Plus" and, provided there are file folder transactions recorded on the handheld portable unit, will automatically transfer that data into MasterTrak Plus and update the Main and History databases accordingly. The user is no longer required to "Download" and "Process" the data themselves within MasterTrak Plus.

### PORTATRAK

The software used on the Windows® CE compatible handheld portable is called PortaTrak, and is pre-installed at no additional charge on all supplied units. Within PortaTrak are the Check In / Out and Physical Inventory modules.

The Check In / Out module allows the User to record file folder movements along with assisting in a complete audit. Also, within this module is an Archive option and this will allow the User to scan file folders into storage boxes for archival purposes.

The Physical Inventory module allows the User to add new file folders to MasterTrak Plus via the handheld portable unit. The information can be entered manually or through the use of pull-down tables and, via MTrak Sync, will automatically update the Main Database in MasterTrak Plus.

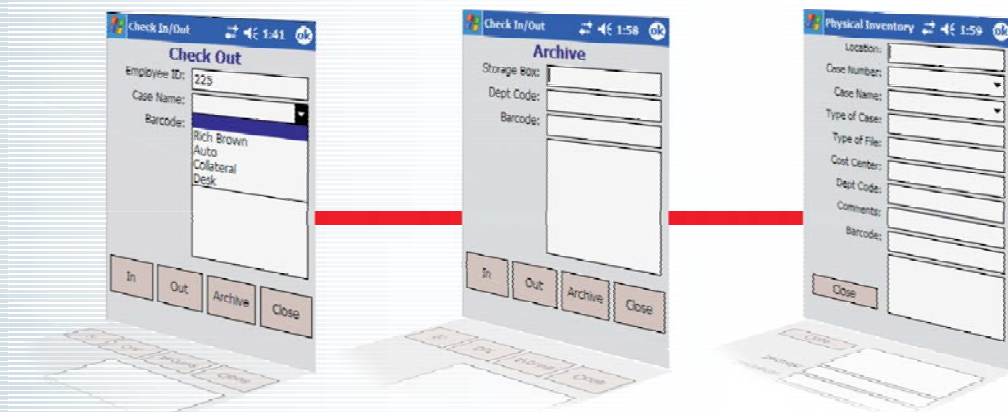

### CUSTOMISE YOUR SCREENS IN PORTATRAK

The User can also customize what fields will be updated in MasterTrak Plus via the handheld portable unit. Through the use of MTrak Sync, the handheld portable unit is also able to receive from MasterTrak Plus all of the existing field titles along with the pull-down table information stored on the Main Database screen. This additional functionality will allow the User to populate the Main Database fields via the handheld portable unit, using the pull-down table information contents.